

- Straight-way type, compact series -

Material:	Nickel-plated brass
Seal:	NBR
Spring:	Stainless steel AISI 302
Opening pressure:	Min. 0.2 bar
Operating pressure:	2.0 to 10.0 bar
Operating temperature:	-10 °C to +70 °C
Port:	M thread acc. to DIN 13 (228.00) G thread acc. to DIN EN ISO 228-1 (228.01 to 228.04)

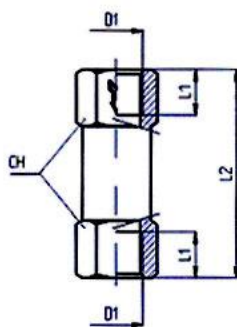
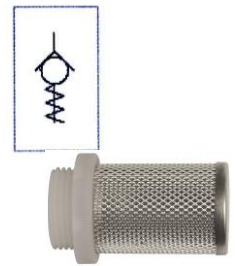

228.02

Unidirectional valves

Art. No.	Type No.	D1	D2	L1	L2	CH	Weight gr.
103840	228.00	M5	2.5	5.0	25.0	8	8.0
103841	228.01	G 1/8	5.0	8.0	36.5	13	25.0
103842	228.02	G 1/4	7.0	9.0	42.5	16	41.0
103843	228.03	G 3/8	10.0	10.5	51.0	20	73.0
103844	228.04	G 1/2	12.0	12.5	62.0	24	120.0

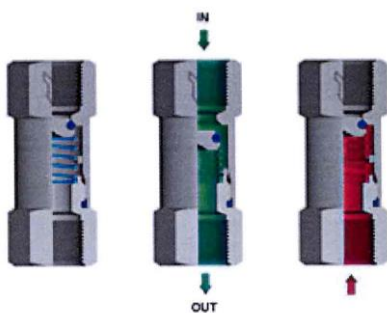

The flow is allowed only one side. Generally the direction according to the on the check valve body identified arrow. The other side remains locked.

Application range:
Pneumatic with filtered or oiled compressed air.

Strainer for check valves, with plastic thread

Art. No. Type No. Thread Mesh size Suitable for check valve Art. No.

134045	SKR-38-K	G 3/8	1.2	103816
134046	SKR-12-K	G 1/2	1.2	103817

Exemplary illustration